

# W8 - 940S

## Fully Automatic winder



High Speed parallel winder for wire

Snap or Clips spool wire securing system

Brushless DC drive motor

Servo motor traverse

Multi-Language text operator panel

CE compliant and approved

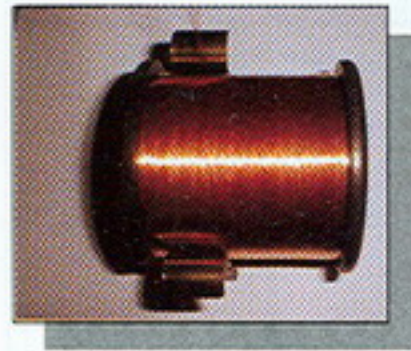
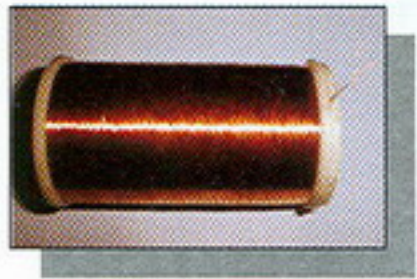

### MACHINE OPERATING PRINCIPLE

The W8-940 has been equipped with internationally accepted components allowing for world wide customer support. Equipped with the most technologically advanced systems, this machine is able to process all **Snap or Clips** style bobbins, and all soft wires **and textile as well**.

**The unit is suitable for processing Wardwell and Schnellflechter or Spirka bobbins, without any conversion kit. Switching from one size to the other by the control panel.**

The servo motor traverse system allows the operator infinite control of the wire guide pitch and ensures precision lay control on the corner build. This system ensures the highest quality bobbins, for optimal braider performance.

The machine has been engineered to meet all CE guidelines. Additionally the ergonomics of the machine have been designed to reduce operator fatigue, and to ensure safety. The operator controls are available in English, German and Italian. (additional languages available upon request)

Utilizing the snap bobbin system to secure the initial and the final end of the wire allows for full automation and maximum braider efficiency. Initial end securing in the snap will result in a tension spike stopping Wardwell braiders before the wire breaks. The final end securing in the snap at the completion of winding eliminates operator wire tying, ensures shipping stability and reduces braider loading time.

Technical specifications	W8-940 Automatic Winder
Number of Spindles	4
Winding Speed	Adjustable 500 to 6000 RPM or Constant linear speed
Maximum traverse length	330 mm.
Maximum bobbin diameter	120 mm.
Traverse control	Infinitely adjustable through control panel
Traverse pitch	Infinitely adjustable through control panel
Length measurement <b>by strokes</b>	Predetermined counter through control panel
Wire Types	Copper, Aluminum, Textile and Soft Steel <b>(max 45 Kg/mm<sup>2</sup>)</b>
Wire Sizes and number of ends	0.4 to 0.05 mm 1 to 12 ends <b>with Copper</b>
Max take-up force on each individual spindle	<b>6 Kg</b>
Dimensions	1320 x 1450 x 1500 mm.
Motor	2.2 Kw. Brushless DC
Net weight	500 kg.
Voltage	To customer specifications

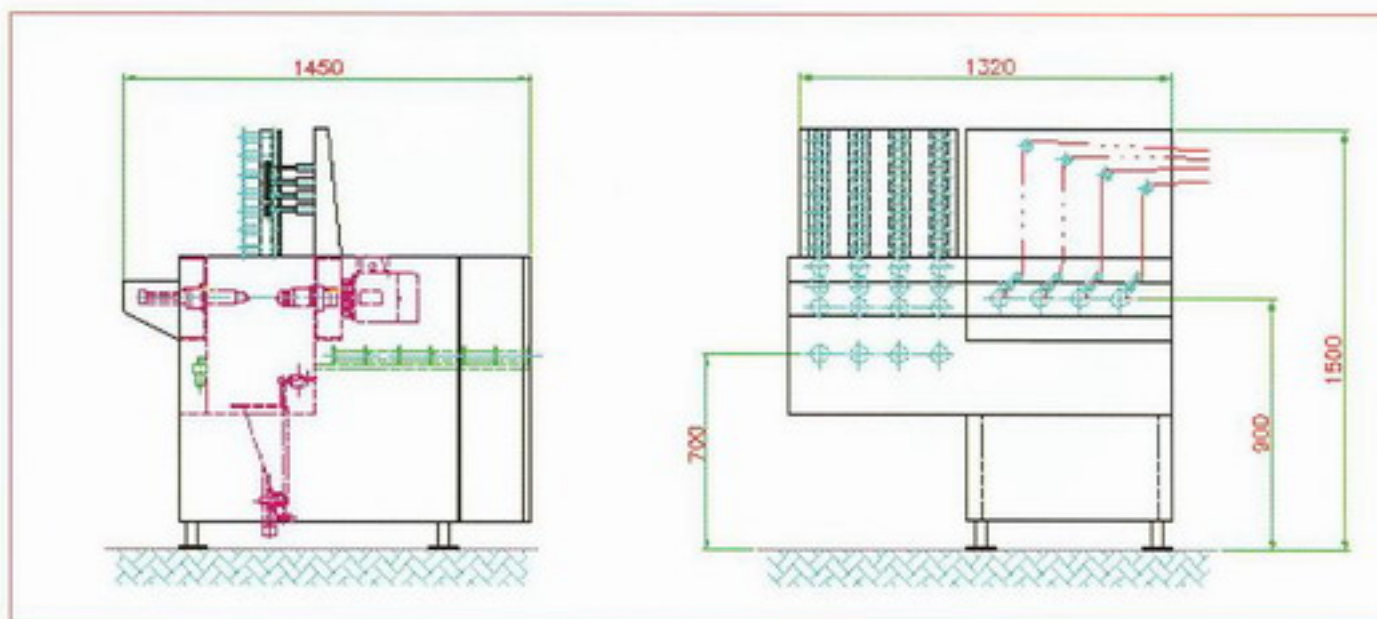

**Wardwell Braiding Machine Company**  
 1211 High Street  
 Central Falls, RI 02863 USA  
 TEL: 401-724-8800  
 FAX: 401-724-2690

**Schnellflechter Berlin GmbH**  
 Rhinstrasse 137  
 D-10315 Berlin Germany  
 TEL: 49-30-5499180  
 FAX: 49-30-54991845